

# 316 Stainless Steel Twin Ferrule Metric Tube Fittings

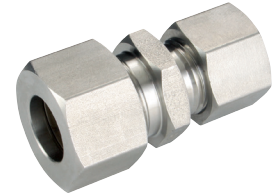

## Reducing Unions

Tube x Tube

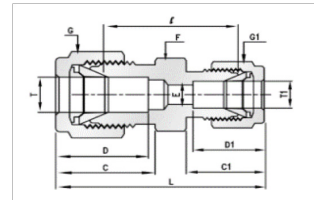

Part No	T mm	T1	E mm	F	G	G1	D	D1	C	C1	I	L
RU-6-3	6	3	2.4	14	14	12	15.3	12.9	17.7	15.3	24.6	38.6
RU-6-4	6	4	2.4	14	14	12	15.3	13.7	17.7	16.1	25.4	39.4
RU-8-6	8	6	4.8	15	16	14	16.2	15.3	18.6	17.7	27.4	42.3
RU-10-6	10	6	4.8	18	19	14	17.2	15.3	19.5	17.7	29.5	44.5
RU-10-8	10	8	6.4	18	19	16	17.2	16.2	19.5	18.6	30.0	45.1
RU-12-6	12	6	4.8	22	22	14	22.8	15.3	22.0	17.7	29.5	47.0
RU-12-8	12	8	6.4	22	22	16	22.8	16.2	22.0	18.6	30.2	47.8
RU-12-10	12	10	7.9	22	22	19	22.8	17.2	22.0	19.5	31.0	48.7
RU-16-12	16	12	9.5	24	25	22	24.4	22.8	22.0	22.0	31.8	52.0
RU-25-18	25	18	15.0	35	38	30	31.2	24.3	26.4	22.1	38.5	61.1
RU-25-20	25	20	15.9	35	38	32	31.3	26.0	26.5	22.0	39.9	62.3