

316 Stainless Steel Twin Ferrule Imperial Tube Fittings

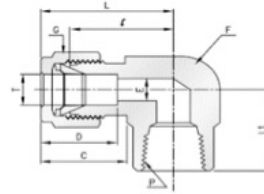

Female Elbows

Female Thread, NPT



PART NO	T in	P (NPT)	E min	F	G	D	C	I	L	L1
FE-125-125N	1/8	1/8	2.28	1/2	7/16	12.70	15.24	18.03	24.63	19.05
FE-125-250N	1/8	1/4	2.28	11/16	7/16	12.70	15.24	20.62	27.82	22.35
FE-187-125N	3/16	1/8	3.04	1/2	1/2	13.71	16.00	18.79	25.40	19.05
FE-250-125N	1/4	1/8	4.82	1/2	9/16	15.24	17.78	19.55	26.92	19.05
FE-250-250N	1/4	1/4	4.82	11/16	9/16	15.24	17.78	22.35	29.71	22.35
FE-250-375N	1/4	3/8	4.82	13/16	9/16	15.24	17.78	24.38	31.75	22.35
FE-250-500N	1/4	1/2	4.82	1	9/16	15.24	17.78	27.17	34.54	28.44
FE-312-125N	5/16	1/8	6.35	9/16	5/8	16.25	18.54	21.33	28.70	19.05
FE-312-250N	5/16	1/4	6.35	11/16	5/8	16.25	18.54	23.11	30.48	22.35
FE-375-125N	3/8	1/8	7.11	5/8	11/16	16.76	19.30	23.11	30.48	19.05
FE-375-250N	3/8	1/4	7.11	11/16	11/16	16.76	19.30	23.87	31.24	22.35
FE-375-375N	3/8	3/8	7.11	13/16	11/16	16.76	19.30	25.90	33.27	22.35
FE-375-500N	3/8	1/2	7.11	1	11/16	16.76	19.30	28.70	36.06	28.44
FE-500-250N	1/2	1/4	10.41	13/16	7/8	22.86	21.84	25.90	36.06	22.35
FE-500-375N	1/2	3/8	10.41	13/16	7/8	22.86	21.84	25.90	36.08	22.35
FE-500-500N	1/2	1/2	10.41	1	7/8	22.86	21.84	28.70	38.86	28.44
FE-625-375N	5/8	3/8	12.70	15/16	1	24.38	21.84	27.94	38.10	20.35
FE-625-500N	5/8	1/2	12.70	1	1	24.38	21.84	29.71	39.87	28.44
FE-750-500N	3/4	1/2	15.74	1-1/16	1-1/8	24.38	21.84	29.71	39.87	28.44
FE-750-750N	3/4	3/4	15.74	1-1/4	1-1/8	24.38	21.84	34.54	44.70	31.75
FE-875-750N	7/8	3/4	18.28	1-1/4	1-1/4	25.90	21.84	34.54	44.70	31.75
FE-1000-750N	1	3/4	22.35	1-27/64	1-1/2	31.24	26.41	36.83	49.02	31.75
FE-1000-1000N	1	1	22.35	1-11/16	1-1/2	31.24	26.41	38.10	50.29	38.10