

Quick Release Pneumatic Hose Couplings



SSC Claw Couplings

SS1 Hose Tail

- Extremely robust, durable coupling of forged steel, hardened, zinc plated and yellow passivated (free of chrome VI), equivalent to type Atlas Copco
- With oil-resistant rubber ring GOER, on request with steam-resistant rubber ring GDOR (up to 200°C) against extra charge
- Maximum bore for maximum flow capacity to reach full tool performance
- Turned gasket seat, therefore 100% tight
- Turned stem profile for perfect fit of the hose
- High quality coupling for compressed air in construction and industry



 Working Pressure:
175 psi

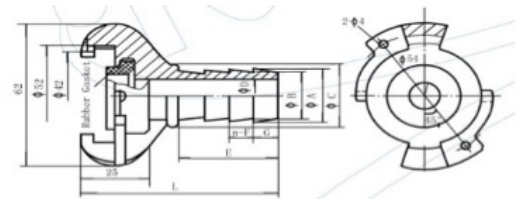

PART NO	SIZE	A	B	C	D	L	E	G	n	F	W.P
SS112	1/2"	15	13	24	8	80	40	10	3	10	175psi
SS134	3/4"	20.3	18.5	32	13.5	84	46	8	4	8	175psi
SS11	1"	26.6	24.6	38	17.5	86	48	10	3	10	175psi