

# Male Stud Elbow, API, Metric

# Wade

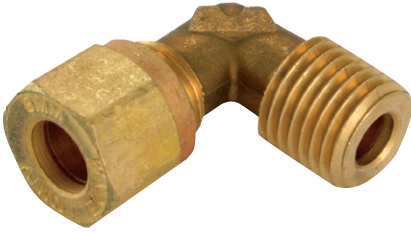

## Features & Benefits

- 90° Elbow configuration with an API male stud thread
- Enables tube connection to a mating API or NPT female threaded port

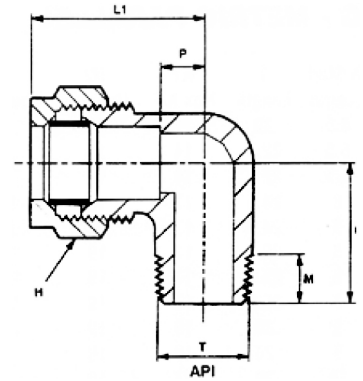

Part No	Tube OD	T API Male Thread	M Stud Length	L1 Length	L2 Length	H Hex A/F	P Abutment
WADE-ME106/085	6	1/8"	9.5mm	24mm	20.5mm	12mm	10.5mm
WADE-ME106/165	6	1/4"	10.5mm	24mm	20.5mm	12mm	10.5mm
WADE-ME108/165	8	1/4"	10.5mm	25.5mm	20.5mm	14mm	10.5mm
WADE-ME110/165	10	1/4"	10.5mm	28.5mm	23.5mm	19mm	13.5mm