



Self-Venting System

Nominal Diameter

10

= 80 mm²

RECTUS Se



27K

70% of actual size



NEW

You will find the following alternative versions in our current catalogue on page:

- ▶ Brass/Steel Single Shut-off P. 95
- ▶ Brass/Steel Double Shut-off P. 139
- ▶ Stainless Steel Single P. 176
- ▶ Stainless Steel Double P. 193

Technical Description

With nominal diameter 10, the largest range in a new generation of couplings with ventilation technology. Two-stage uncoupling prevents occurrence of the whiplash effect.

Advantages

Connected in the same manner as all standard couplings – single hand operation. The venting takes place without any danger to the operators during the disconnecting process – no danger of being hit by a whipping hose that is still pressurized. The system fulfils the requirements stipulated in ISO 4414 for increased safety standards in the working place.

Working Pressure

PB = 12 bar, maximum static working pressure with safety factor of 4 to 1.

Working Temperature

-20°C up to +60°C (NBR) depending on the medium.

Caution

Not recommended for direct connection to compressed air tools. Reliable functioning can only be guaranteed in conjunction with original RECTUS plug made of steel.

Chart

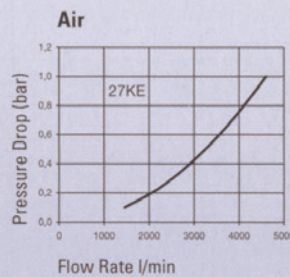

Material

Coupling

Back Body
Valve Body
Sleeve
Valve
Spring
Locking Balls
Seals

Standard Version

Brass, Nickel Plated
Steel, Nickel Plated
Polyamide, fiber glass reinforced
Brass
AISI 301
AISI 420
NBR

Plug

Steel, Hardened, Nickel Plated

Couplings

RECTUS Series 27K

	Connection A	Hex SW	L mm	D mm	L1 mm	L2 mm	H mm	B mm	G mm	Version	Part Number
<p>Male Thread</p>	R 3/8	27	79	38	9					Standard	27KE AK17 SPN
	R 1/2	27	80,5	38	12					Standard	27KE AK21 SPN
	R 3/4	32	86	38	16					Standard	27KE AK26 SPN
<p>Female Thread</p>	G 3/8	27	83	38	14					Standard	27KE IW17 SPN
	G 1/2	27	84	38	14					Standard	27KE IW21 SPN
	G 3/4	32	86	38	14					Standard	27KE IW26 SPN

RECTUS Series 27KE

Connection A	Hex SW	L mm	D mm	L1 mm	L2 mm	H mm	B mm	G mm	Version	Part Number	DS
6 mm		48	15	25					Standard	27SF TF06 SXN	■
8 mm		48	15	25					Standard	27SF TF08 SXN	■
9 mm		48	15	25					Standard	27SF TF09 SXN	■
10 mm		48	15	25					Standard	27SF TF10 SXN	■
13 mm		48	15	25					Standard	27SF TF13 SXN	■
16 mm		49	18	25					Standard	27SF TF16 SXN	■
19 mm		49	18	25					Standard	27SF TF19 SXN	■

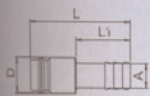

Hose Barb

RECTUS Series 27KE

Connection A	Hex SW	L mm	D mm	L1 mm	L2 mm	H mm	B mm	G mm	Version	Part Number	DS
R 1/4	17	40		12					Standard	27SF AK13 SXN	■
R 3/8	17	40		12					Standard	27SF AK17 SXN	■
R 1/2	22	45		17					Standard	27SF AK21 SXN	■
R 3/4	27	48		19					Standard	27SF AK26 SXN	■
G 1/4	17	33		9					Standard	27SF IW13 SXN	■
G 3/8	19	33		9					Standard	27SF IW17 SXN	■
G 1/2	24	37		12					Standard	27SF IW21 SXN	■
G 3/4	32	42		16					Standard	27SF IW26 SXN	■

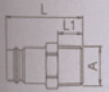

Male Thread



Female Thread